

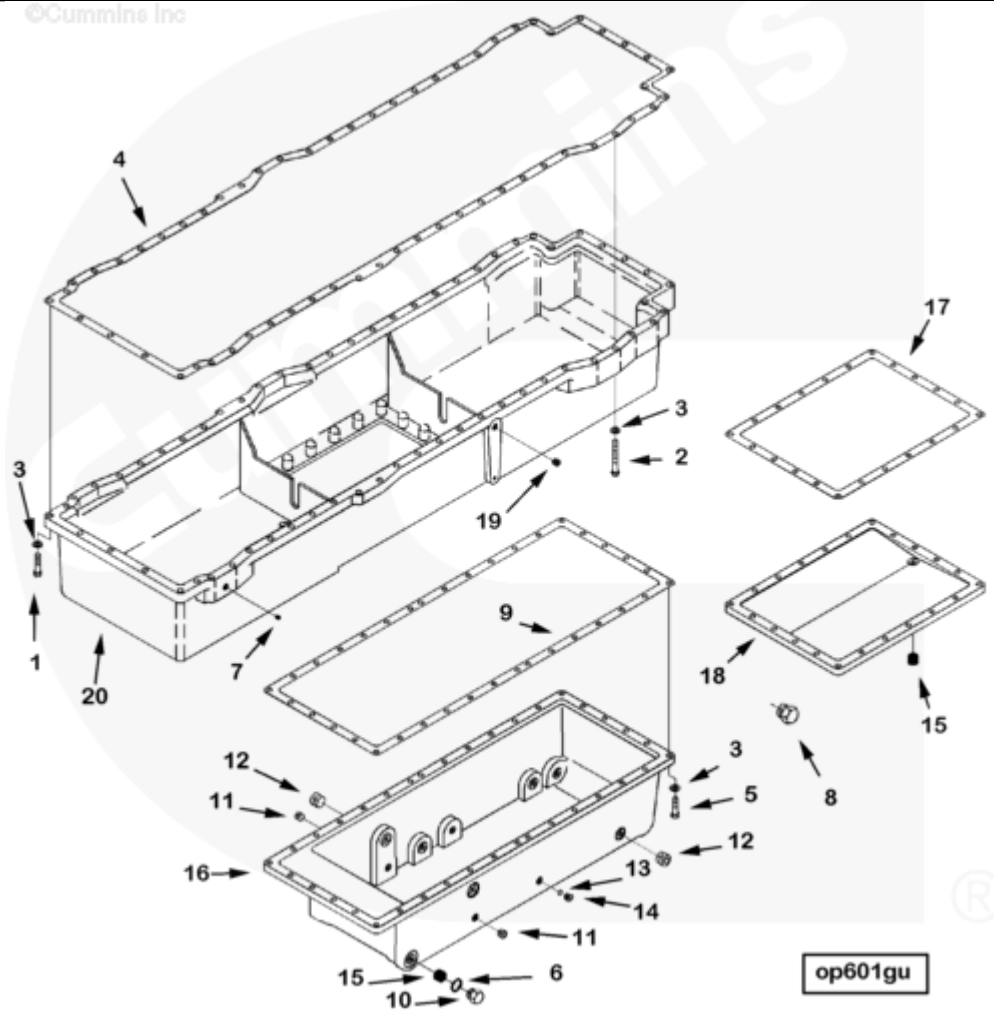

Parts Catalog - Option Detail

Electronic Parts Catalog - Option Detail				
Option	Group	Graphic	Film Card	Date
OP6071-02	07.01	op601gu	K38	22-MAY-00
Engines	GTA38, K38, KTA38GC CM558, QSK38 CM2150 K106, QSK38 CM2150 MCRS, QSK38 CM850 MCRS			



[SMALL](#) | [MEDIUM](#) | [LARGE](#)

Cart	Ref No	Part Number	Part Description	Required	Remarks
View My Cart					
		OP6071-02	Oil Pan		High capacity rear/center...(More)
					sump oil pan. Oil pan
					adapter with removable front
					end cover and removable

					rear/center sump. Sump is
					mounted with longest flange
					towards the rear angularity:
					(Unknown) oil pan capacity:
					* High Level: 37 US Gallons
					* Low Level: 30 US Gallons
					for KTA38M2 engines only.
<input type="checkbox"/>	1	106069	Hexagon Head Cap Screw	31	7/16 - 14 X 2 in.
<input type="checkbox"/>	2	108767	Hexagon Head Cap Screw	29	7/16 - 14 X 3 1/2 in.
<input type="checkbox"/>	3	3000082	Plain Washer	118	15/32 in.
<input type="checkbox"/>	4	3043212	Oil Pan Gasket	1	
<input type="checkbox"/>	5	S 140	Hexagon Head Cap Screw	58	7/16 - 14 x 1 3/4 in.
<input type="checkbox"/>	6	67946	Plain Washer	4	1 1/32 in.
<input type="checkbox"/>	7	3002158	Pipe Plug	2	1/8 NPT.
<input type="checkbox"/>	9	3043214	Oil Pan Gasket	1	
<input type="checkbox"/>	10	3055069	Threaded Plug	4	1 - 18 UNS.
<input type="checkbox"/>	11	3628606	Pipe Plug	3	1/2 - 14.
<input type="checkbox"/>	12	3628608	Pipe Plug	3	
<input type="checkbox"/>		3037536	Threaded Plug	2	9/16 - 18 UNF
<input type="checkbox"/>	13	3037537	O-Ring Seal	2	
	14	3040813	Threaded Plug	2	9/16 - 18 UNF
<input type="checkbox"/>		3088853	Oil Pan	1	
<input type="checkbox"/>	15	200845	Threaded Insert	2	
	16	3630256	Oil Pan	1	
<input type="checkbox"/>	8	3032629	Threaded Plug	2	1 5/16 - 12 UNF.
<input type="checkbox"/>	17	3043211	Oil Pan Gasket	1	
		3028696	Oil Pan Cover	1	
<input type="checkbox"/>	15	200845	Threaded Insert	1	
	18	206099	Oil Pan Cover	1	

<input type="checkbox"/>		3630545	Oil Pan Adapter	1	
<input type="checkbox"/>	19	3628609	Pipe Plug	1	3/8-18.
	20	3630262	Oil Pan Adapter	1	

© 2019 Cummins Inc., Box 3005, Columbus, IN 47202-3005 U.S.A.
 Terms of Use and Disclaimers | Recommended System Requirements
 Need Assistance? Please click on the Contact Us button in the top right corner of any page.